

HOW TO COVER APPLIANCES

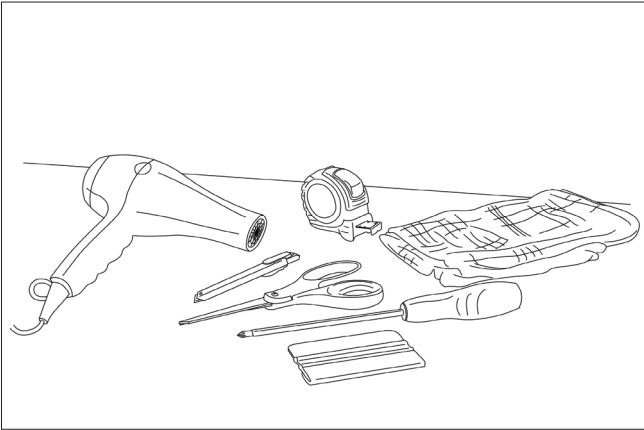

1. Tools

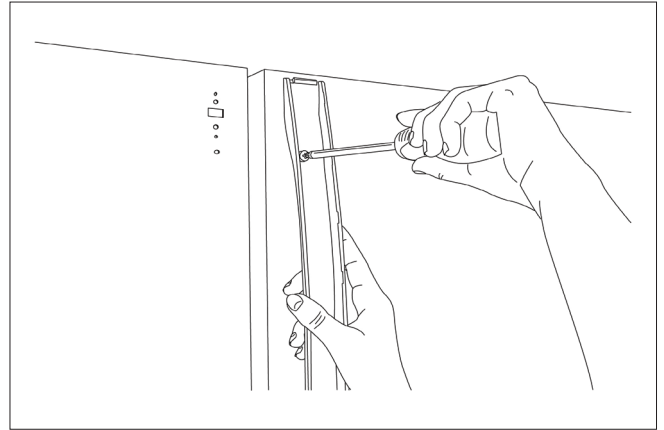

2. Remove handles

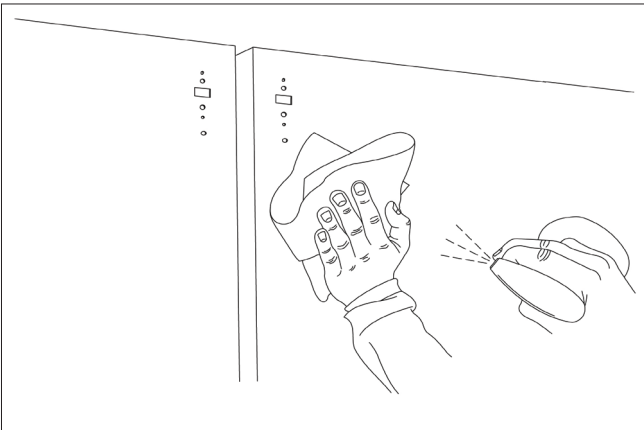

3. Clean

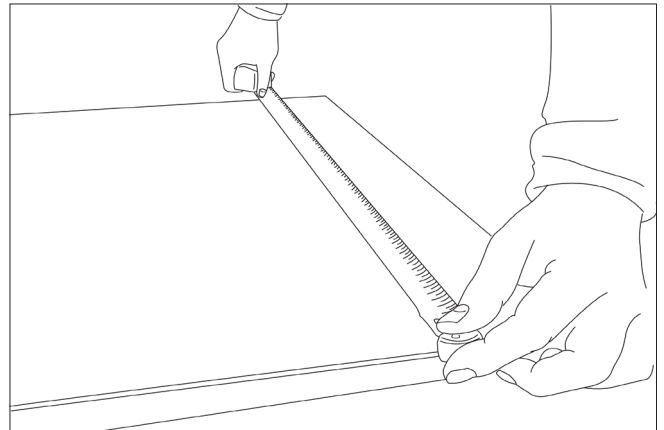

4. Measure

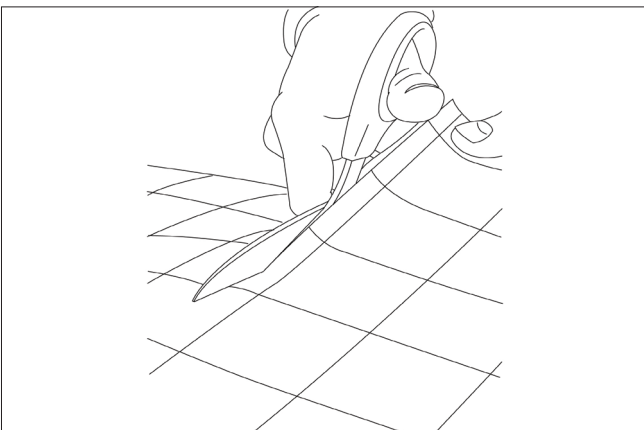

5. Cut

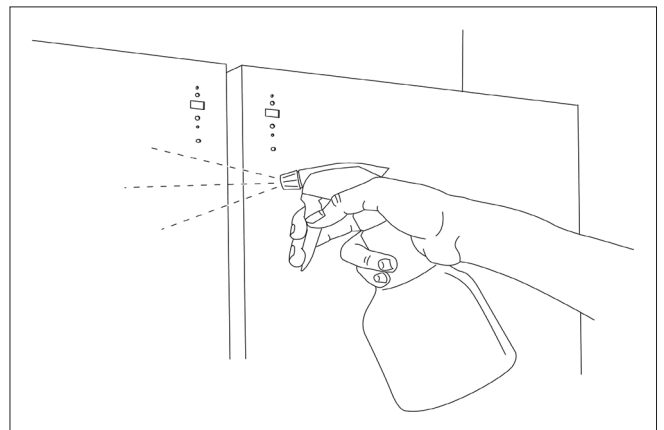

6. Spray surface with water

HOW TO COVER APPLIANCES

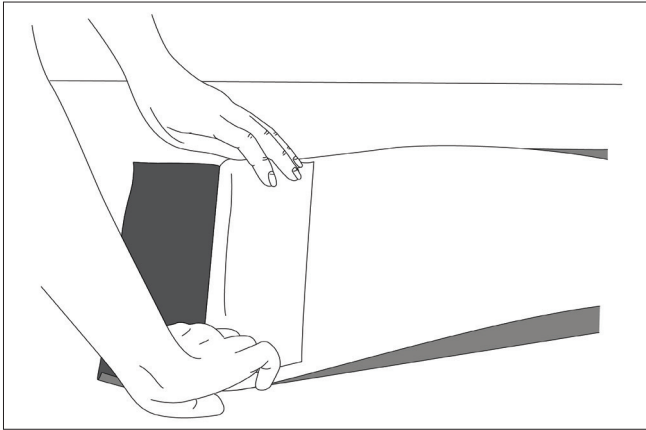

7. Peel away a small section of backing paper

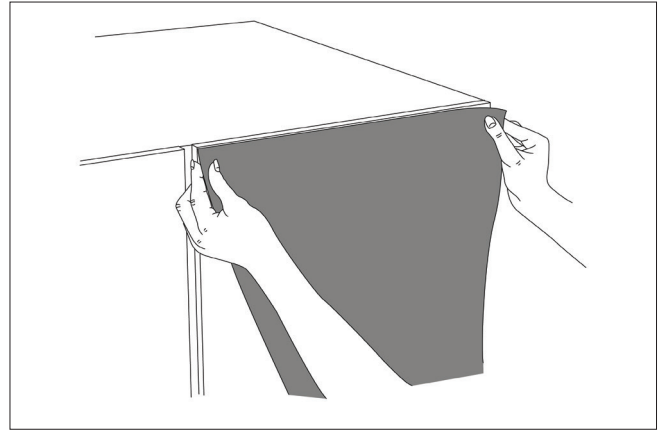

8. Apply the revealed sticky section of the film, lining up with the top of the door

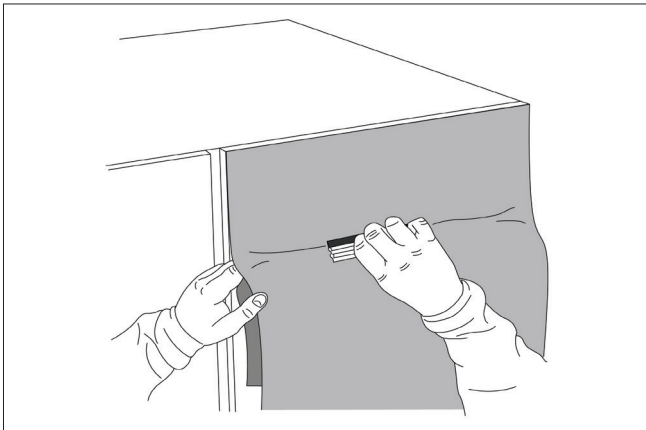

9. Smooth into place gradually peeling away the backing paper

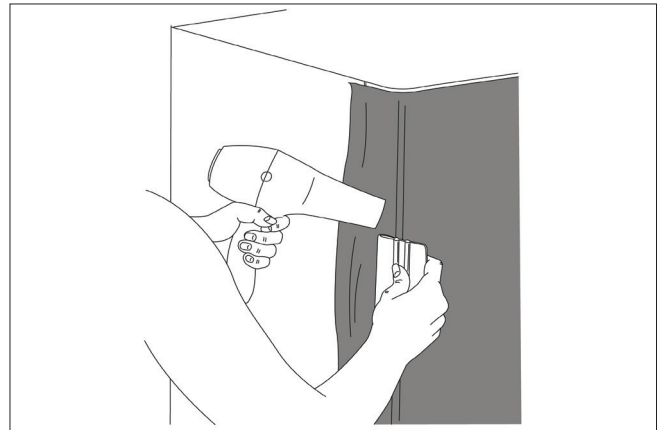

10. Use a hairdryer on a low setting to smooth around the edge

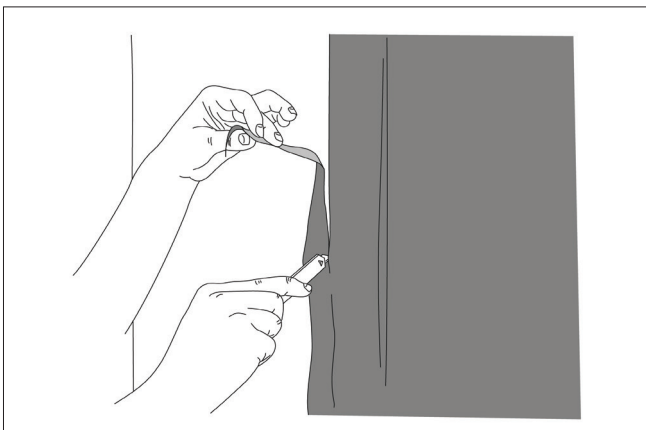

11. Trim